

SPRING LOADED BALL CARTRIDGES

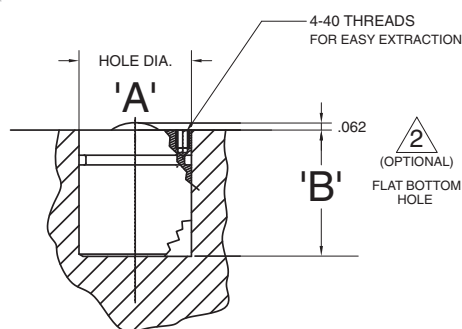

MANY NON-STANDARD & CUSTOM SIZES AVAILABLE

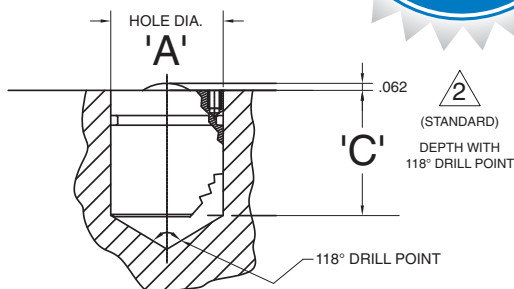
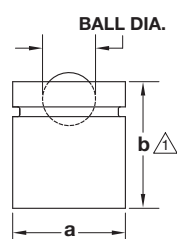

| Part No. | Allowable Load lbs. per Cartridge | Ball Diameter | a | b | Hole A +.005 -.000 | Hole B +.005 -.000 | Hole C +.005 -.000 |
|-----------|--------------------------------------|---------------|--------|-------|-----------------------|-----------------------|-----------------------|
| MR-305-12 | 45 lbs. | 3/8 | 3/4 | 1-1/8 | .750" | 1.130" | 1.110" |
| MR-305-13 | 45 lbs. | 3/8 | 13/16 | 1-1/8 | .813" | 1.130" | 1.110" |
| MR-305-15 | 70 lbs. | 15/32 | 15/16 | 1-1/8 | .937" | 1.130" | 1.110" |
| MR-305-16 | 70 lbs. | 15/32 | 1 | 1-1/8 | 1.000" | 1.130" | 1.110" |
| MR-305-19 | 115 lbs. | 5/8 | 1-3/16 | 1-3/8 | 1.187" | 1.375" | 1.355" |
| MR-305-21 | 115 lbs. | 5/8 | 1-5/16 | 1-3/8 | 1.312" | 1.375" | 1.355" |
| MR-305-25 | 150 lbs. | 7/8 | 1-9/16 | 1-3/4 | 1.562" | 1.770" | 1.750" |
| MR-305-26 | 200 lbs. | 7/8 | 1-5/8 | 1-3/4 | 1.625" | 1.770" | 1.750" |

¹ Use hole information for mode exact dimensions and proper bolster modifications.

² Please note difference in hole depth. Drill point allows cartridge to sit deeper due to chamfer on bottom of cartridge housing.

Damaged cartridges can readily be extracted and replaced. Thread a 4-40 UNC screw into the thread hole and pull cartridge out.

Model 305 allows movement of dies in any direction. A push of about 2-4% of die weight is usually required to move a die.

Install a pattern of Model 305 on a press bolster. Keep die weight and footprint in mind to ensure that a die can be adequately supported. When a die is clamped, the die lifter cartridges under the die will compress.