

THE GTP-45 DELIVERS 600# OF GRIP FORCE IN A TWO OR THREE FINGER CONFIGURATION

# SINGLE ACTING ROBOTIC GRIPPERS

**1200:1 FORCE WEIGHT RATIO**  
**600# FORCE**

### Light Weight

At less than eight ounces, these featherweight grippers provide an unprecedented grip force to weight ratio.



### Multiple Jaw Configurations

6° Gripper available in two or three finger, expanding or contracting styles. 12° Gripper available in two finger contracting style.

### Large Grip Force

Large piston areas and toggle linkages generate 600# grip force @ 100 psi and 0° travel point (520# for the 12° contracting type).

### Modular

Recess mount and universal mount available to mount in our Compliance Device (RCC) or your own mountings.

### Single Acting

Spring quickly returns gripper to the original position.

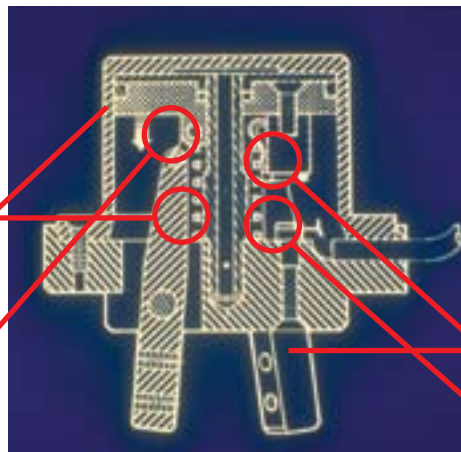

### High Strength Materials

Hardened parts ensure low wear and long lasting ±0.2 Degree repeatability.

### Positive Part

Pick-up Activating magnet trips sensor if part is not present (Gripper travels 1/2° past grip point).

### Hall Effect Sensors

Available in either current sourcing or sinking type - 6-24 VDC (13mA max supply/ 20mA max output) switching time of .2 Microseconds

## RECESSED MOUNT (R)

FITS ASP 85 AND AST 100  
REMOTE CENTER COMPLIANCE DEVICES

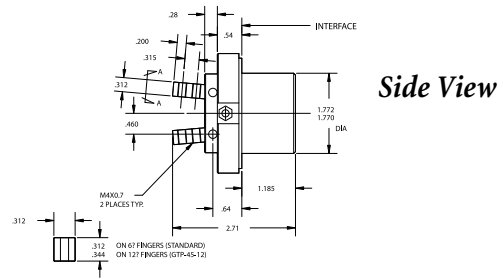
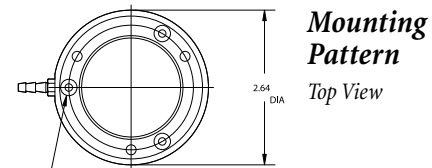

## UNIVERSAL FLANGE MOUNT (U)

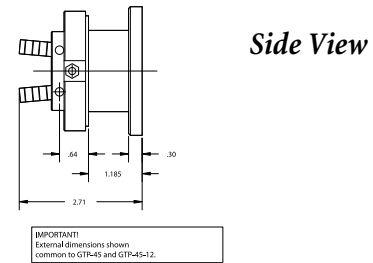
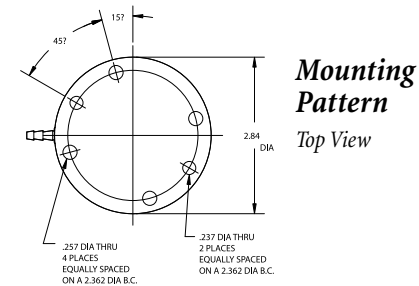

## FINGER OPTIONS (2 OR 3 FINGERS)

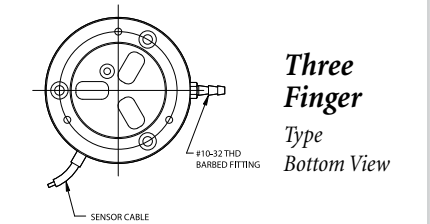
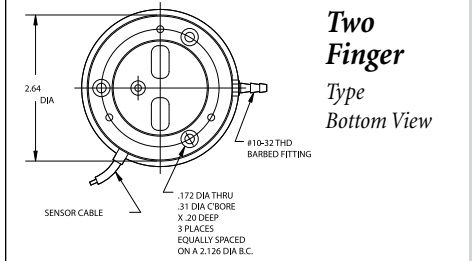

NOTE: DIMENSIONS ARE IN INCHES EXCEPT WHERE NOTED.

## FINGER TRAVEL

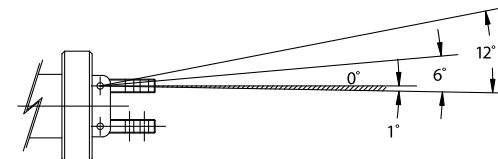

### Contracting (C)

Fingers start at the outer position and contract inward to grip object at the zero degree position

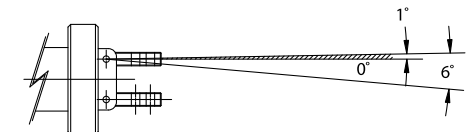

### Expanding (E)

Fingers start at the inner position and expand outward to grip object at the zero degree position

## IDENTIFY YOUR PART NUMBER

Gripper Designation	Mounting	Finger Style	Activation	Finger Travel	Optional Sensor Type
	R = Recessed U = Universal	2 = Two Finger 3 = Three Finger	C = Contracting X = Expanding	6° = All Styles 12° = Two Finger Closing Only	SI = Sinking SO = Sourcing O = None
GTP-45	R	3	C	6	SI

Example Part No: **GTP-45R-3C-6-SI**

pfa-inc.com